

SAMPLE FULLY ADHERED TPO SPEC

10/17/2019

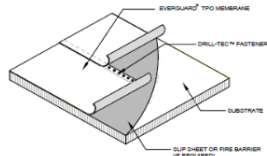

SPECIFICATION: TFANI60

COMPONENT	TYPE	REQUIRED	ATTACHMENT	RATE OF APPLICATION
DECK	Structural Concrete		Per Code	
PRIMER	GAF® SA Primer	One (1) coat	Brush, roller or sprayer	0.5-0.66 gallons per 100 sq. ft.
VAPOR RETARDER	GAF® SA Vapor Retarder	One (1) layer	Membrane adhered to primed deck.	Adhered Per GAF® requirements
THERMAL BARRIER	DensDeck® Prime Roof Board or Securock® Gypsum Fiber Roof Board ASTM C-1278	One (1) layer Min. ¼"	OlyBond500™ Roofing Adhesive Equipment-Free Canister System	Field: 1.25" ribbons 12" o.c. Perimeter: 1.25" ribbons 6" o.c. Corners: 1.25" ribbons 6" o.c.
INSULATION	EnergyGuard™ PolyIso Roof Insulation ASTM C-1289	One (1) layer Min. 1.5"	OlyBond500™ Roofing Adhesive Equipment-Free Canister System	Field: 1.25" ribbons 12" o.c. Perimeter: 1.25" ribbons 6" o.c. Corners: 1.25" ribbons 6" o.c.
ROOF BOARD	DensDeck® Prime Roof Board or Securock® Gypsum Fiber Roof Board ASTM C-1278	One (1) layer Min. ¼"	OlyBond500™ Roofing Adhesive Equipment-Free Canister System	Field: 1.25" ribbons 12" o.c. Perimeter: 1.25" ribbons 6" o.c. Corners: 1.25" ribbons 6" o.c.
SINGLE PLY MEMBRANE	EverGuard® TPO 60 mil ASTM D-6878	One (1) ply	EverGuard® TPO Quick Spray Adhesive LV50	Spraying from 8" -12" away, apply adhesive equally to both the substrate and underside of membrane.
FLASHING MEMBRANE	EverGuard® TPO 60 mil ASTM D-6878	One (1) ply	EverGuard® TPO Quick Spray Adhesive LV50	Spraying from 8" -12" away, apply adhesive equally to both the substrate and underside of membrane.
GUARANTEE	WeatherStopper® EverGuard® Diamond Pledge™ NDL Roof Guarantee	Twenty (20) years		GUARANTEE FEE APPLICABLE

All GAF® and EverGuard® accessories shall be used where applicable.

GAF® Perimeter Edge Metal shall be used where conditions exist.

This system shall be installed by a GAF® Master or Master Select™ Contractor.

Each roof has unique requirements. This specification is a graphic representation of products and their installation.

To properly assess specific roofing needs, code compliance, system configurations and warranty eligibility, contact Contractor Services. Note: Your Field Services or Technical Services Managers are the only employees who can approve any deviation from GAF's published specification manual(s). Always review the appropriate Application & Specification Manual before commencing this project, as the Manual may contain information that is important for a successful installation.

This Cut Spec specification shall not waive, supersede or alter the requirements and recommendations found in the most current Application & Specification Manual(s) referenced above, printed technical bulletins or specific correspondence drafted for this project by Field Services or Technical Services Manager.

Architectural Information Services ais@gaf.com 1-800-522-9224